

Vivinex™ multiSert™

Single use injector with preloaded

Vivinex™ IOL Model **XC1-SP, XY1-SP, XY1A-SP, XY1-EM, XY1-G(T) or XY1-GP(T)**



Display numbers ①, ② and ③ are marked on the injector case or injector cover to handle the **multiSert™** injector in the proper sequence.

Step A

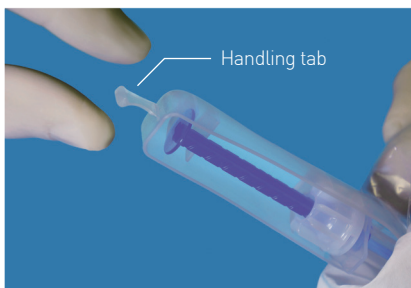

Pull the injector out of the pouch by holding the handling tab.

Step B

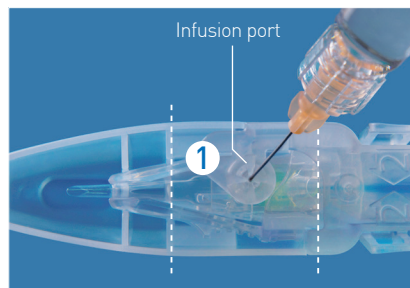

Infuse the sodium hyaluronate OVD into the injector through the infusion port. Fill up the area indicated by the dotted lines with the OVD, and confirm the OVD has reached the entire optic.

Step C

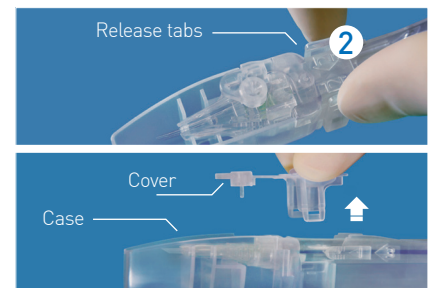

Press the release tabs, lift up and remove the cover from the injector case.

Step D

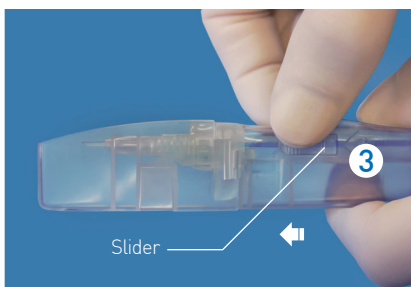

Hold injector body with thumb and slowly push the slider forward in an even manner for about 3 seconds, without applying upward or downward pressure, until it stops at the injector case.

Step E

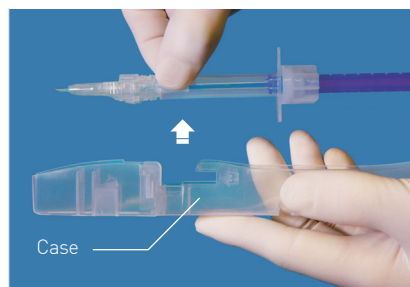

Remove the injector from the case. Go immediately to the next step once removed.

Step F

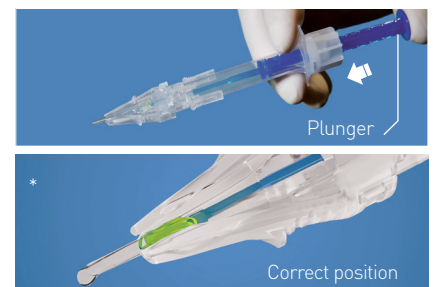

Gently advance the plunger forward in one smooth, continuous motion until haptic tucking state reaches the specific position as illustrated in the image (*). This plunger advancement should require about 5 seconds.

Confirmation of correct position: Pay special attention that the trailing haptic is tucked correctly as the rod advances to the back edge of the optic. As the lens advances further, confirm that the leading and trailing haptic are tucked correctly, and that the rod tip pushes the edge of the optic in the center.

4-in-1 **multiSert™** offers unmatched control with multiple options

Step G



Insertion options

Delivery into capsular bag

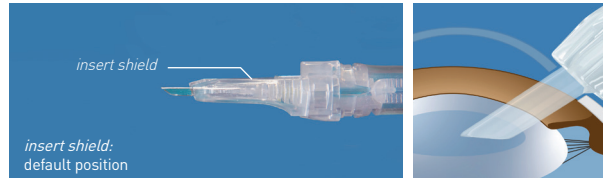

Use injector without moving *insert shield* from its default position. Place slit of injector tip in a downward position before inserting into incision of eye.

Delivery through incision wound tunnel

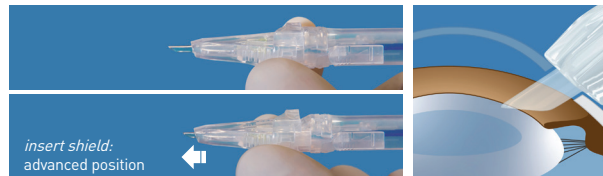

Hold the injector body and slide the *insert shield* gently forward until it stops with a click at the final position. Place slit of injector tip in a downward position before inserting into incision of eye. Insert up to the advanced *insert shield*.

multiSert™

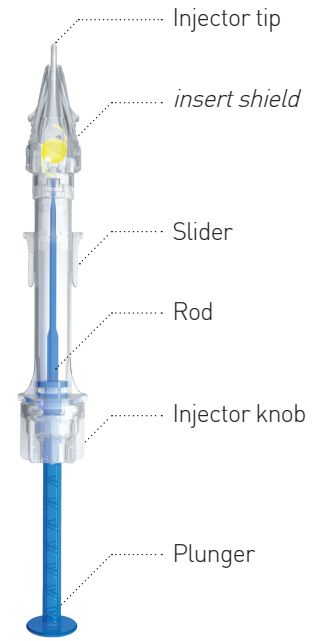

Step H



Injection options

Single-handed push injection



Slowly push the plunger forward to insert the lens into the capsular bag.

Two-handed screw injection

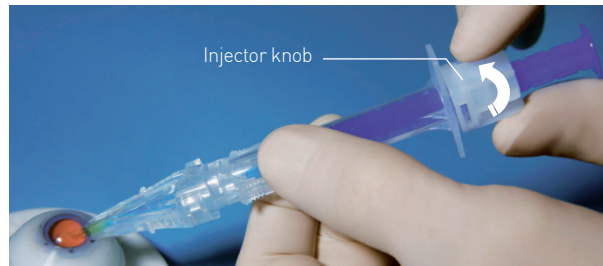

Slowly rotate the injector knob clockwise to insert the lens into the capsular bag.

! For both injection options applies:
DO NOT pull the plunger back or turn the knob in reverse direction during advancement.
Rotation of the injector is NOT required.